



ESL 55-12FT



Application

- Telecom
- Communication Equipment
- Control Equipment
- Medical Equipment
- UPS
- Emergency Power System

General Features

- Easy maintenance and installation
- No need for extra (wrench space) above battery
- Sealed and maintenance free operation
- Non-Spillable construction design
- ABS containers and covers(UL94HB, UL94V-0) optional
- Safety valve installation for explosion proof
- Maximized energy density for installation in relay rack trays
- High quality and high reliability
- Exceptional deep discharge recovery performance
- Flexibility design for multiple install positions

Construction

- Component.....Raw material
- Sealant.....Epoxy Resin
- PositiveLead dioxide
- Safety valveEPDR
- NegativeLead

- TerminalCopper
- CoverABS
- ElectrolyteSulfuric acid
- SeparatorFiber glass
- ContainerABS

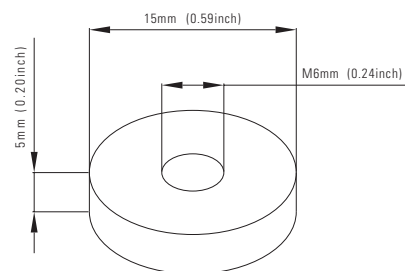

Terminal Dimensions

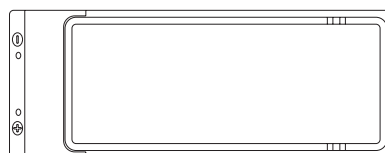
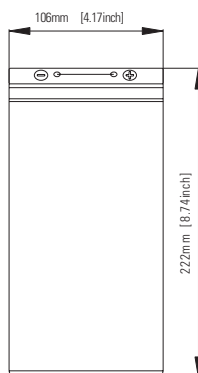
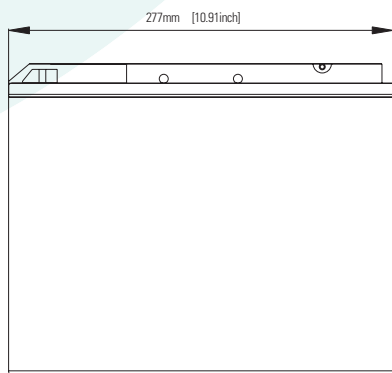

Battery Model	ESL 55-12FT			
Designed Floating Life	12 Years			
Capacity (25°C)	20HR(2.75A, 1.80V)	10HR(5.2A, 1.80V)	5HR(9.3A, 1.75V)	1HR(33.5A, 1.60V)
	55AH	52AH	46.5AH	33.5AH
Dimensions	Length	Width	Height	Total Height
	277mm(10.91inch)	106mm(4.17inch)	222mm(8.74inch)	222mm(8.74inch)
Approx. Weight	16.5Kg (36.4 lbs)			
Internal Resistance	Full charged at 25°C			
Self Discharge	3% of capacity declined per month at 25°C			
Capacity Affected by Temp. (20HR)	40°C	25°C	0°C	-15°C
	102%	100%	85%	65%
Charge Voltage (25°C)	Cycle use		Float use	
	14.4-15V(-30mV/ C), max. Current: 14A		13.6-13.8V(-20mV/ C)	

Charge Characteristics

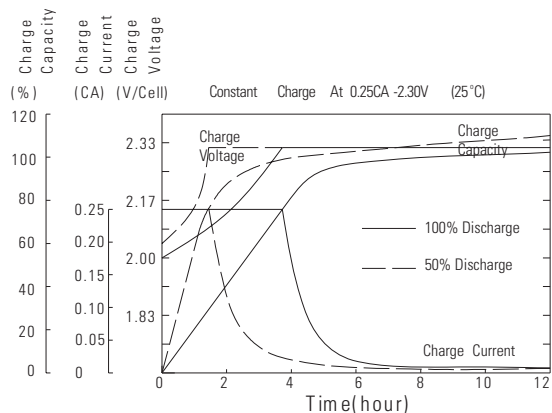

Discharge Characteristics

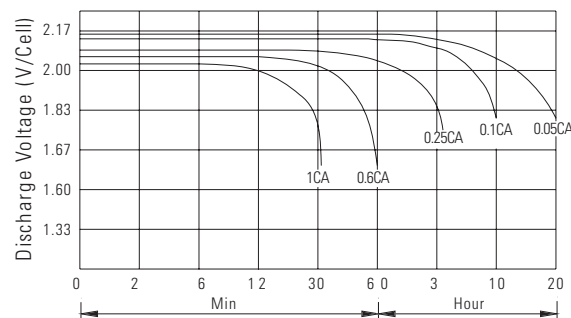

Relationship of OCV and state of charge

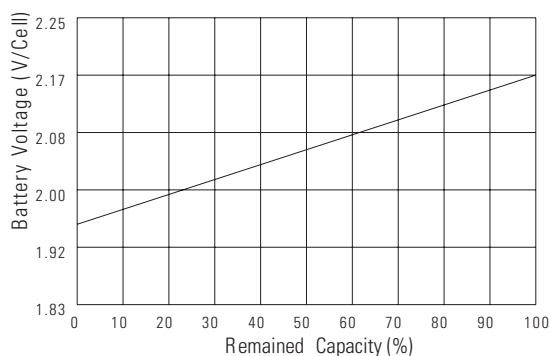

Self Discharge Characteristics

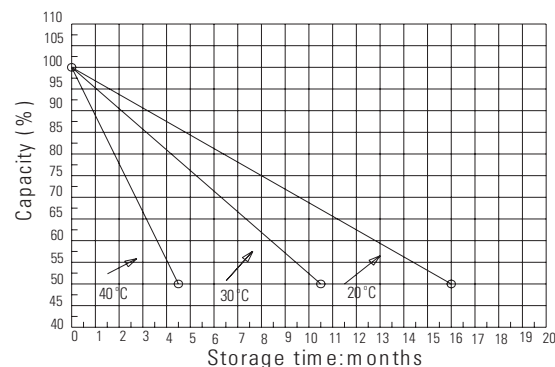

Constant current discharge ratings-amperes at 25°C

FV/Time	5MIN	10MIN	15MIN	30MIN	1HR	3HR	5HR	10HR	20HR
1.60V	193	132	96.3	57.8	36.3	15.0	10.5	5.83	2.90
1.67V	173	120	93.5	56.1	36.2	15.0	10.4	5.74	2.89
1.70V	164	116	90.2	55.0	36.1	15.0	10.4	5.70	2.89
1.75V	146	107	85.3	53.9	35.8	14.9	10.3	5.60	2.88
1.80V	132	100	81.4	52.3	35.3	14.8	10.2	5.50	2.77
1.85V	100	82.0	70.4	48.1	34.9	14.7	10.2	5.41	2.61

Constant power discharge ratings-watts at 25°C

FV/Time	5MIN	10MIN	15MIN	30MIN	1HR	3HR	5HR	10HR	20HR
1.60V	317	219	171	109	71.5	28.8	20.1	11.7	5.80
1.67V	301	216	169	107	69.1	28.8	20.1	11.5	5.78
1.70V	281	211	166	104	67.3	28.8	20.1	11.4	5.78
1.75V	262	197	156	101	66.7	28.4	19.9	11.2	5.75
1.80V	235	183	147	98.5	65.6	28.0	19.5	11.0	5.55
1.85V	188	152	128	90.2	65.0	27.9	19.3	10.8	5.21